

## EL16 L7.05M 2KSG 10 (416 970)

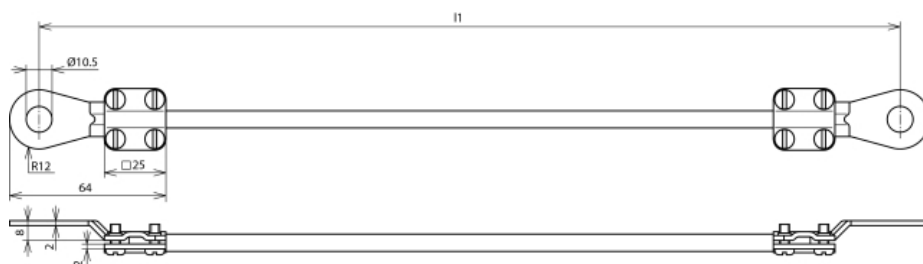

Figure without obligation

| Type  | EL16 L7.05M 2KSG 10 |
|---|---------------------|
| Part No.                                      | 416 970             |
| Cable cross section                           | 16 mm <sup>2</sup>  |
| Cable length (l1)                             | 7.05 m              |
| Cable lug closed                              | 2x M10              |
| Hole Ø  | 10.5 mm             |
| Conductor                                     | Cu highly flexible  |
| Operating voltage resistance (AC / DC)        | 600 V               |
| Temperature range                             | -40 °C ... +150 °C  |
| Colour  | black •             |
| Cable lug material                            | Cu/gal Sn           |
| Screw   | ⬆ M4 x 10 mm        |
| Material of screw                             | St/gal Zn           |
| Standard                                      | EN 62561-1          |
| Weight  | 1,46 kg             |
| Customs tariff number (Comb. Nomenclature EU) | 85444290            |
| Stock No.                                     | 6150-12-168-2692    |
| GTIN  | 4013364029026       |
| PU  | 1 pc(s)             |

We reserve the right to introduce changes in performance, configuration and technology, dimensions, weights and materials in the course of technical progress. The figures are shown without obligation.

Packing in accordance with specifications of the VG standards (defence equipment standards) must be explicitly indicated when ordering.