

EL16 L1.55M KSO 8.10 KSG 8 (416 415)

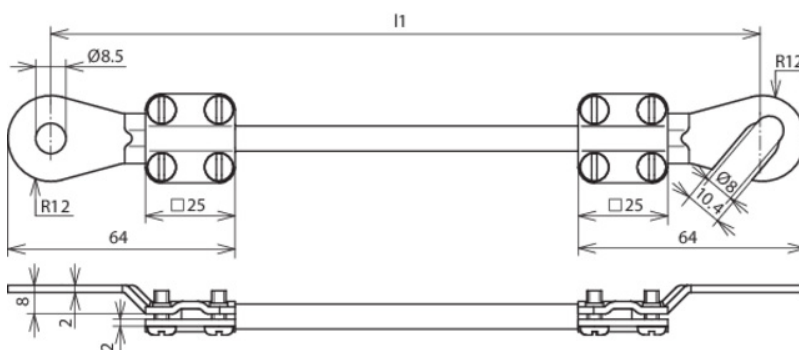

Figure without obligation



Type	EL16 L1.55M KSO 8.10 KSG 8
Part No.	416 415
Cable cross section	16 mm ²
Cable length (l1)	1.55 m
Cable lug open	M8 / M10
Cable lug closed	M8
Hole Ø	8.5 mm
Conductor	Cu highly flexible
Single wire diameter	0.1 mm
Operating voltage resistance (AC / DC)	600 V
Temperature range	-40 °C ... +150 °C
Colour	black •
Cable lug material	Cu/gal Sn
Screw	⬆ M4 x 10 mm
Material of screw	St/gal Zn
Weight	364 g
Customs tariff number (Comb. Nomenclature EU)	85444290
Stock No.	6150-12-308-6981
GTIN	4013364032439
PU	1 pc(s)

We reserve the right to introduce changes in performance, configuration and technology, dimensions, weights and materials in the course of technical progress. The figures are shown without obligation.

Packing in accordance with specifications of the VG standards (defence equipment standards) must be explicitly indicated when ordering.