

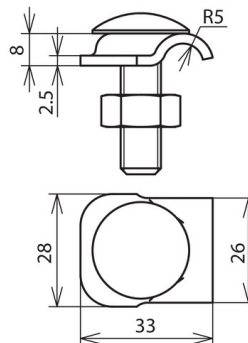

KB 6.10 FRM10X35 V2A (390 159)



Figure without obligation



Arrangement:

Type	KB 6.10 FRM10X35 V2A
Part No.	390 159
Material of clamp	StSt
Clamping range Rd	6-10 mm
Material thickness	2.5 mm
Screw	⬆ M10 x 35 mm
Material of screw / nut	StSt
Screw-retaining thread insert	yes
Lightning current carrying capability (10/350 µs)	/ *)
Standard	EN 62561-1
Weight	61 g
Customs tariff number (Comb. Nomenclature EU)	85359000
GTIN	4013364032200
PU	100 pc(s)

*) For exact assignment, see test certificate.

We reserve the right to introduce changes in performance, configuration and technology, dimensions, weights and materials in the course of technical progress. The figures are shown without obligation.