

BCO CL2 BD 12 (927 942)

- LifeCheck arrester monitoring and integrated status indication
- Compact two-pole arrester for optimal protection of one pair
- For installation in conformity with the lightning protection zone concept at the boundaries from $0_A - 2$ and higher

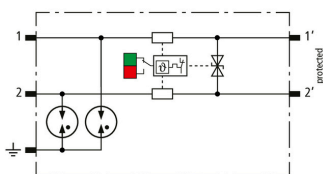

Figure without obligation



Basic circuit diagram BCO CL2 BD 12

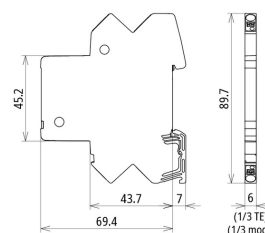

Dimension drawing BCO CL2 BD 12

Space-saving, compact combined arrester with a width of 6 mm and push-in connection technology with status indication for protecting one pair of unearthed balanced interfaces.

Type	BCO CL2 BD 12
Part No.	927 942
SPD class	TYPE 2 P2
Impulse category	D1, C1, C2, C3, B2
Nominal voltage (U_N)	12 V
Max. continuous operating voltage (d.c.) (U_C)	15 V
Max. continuous operating voltage (a.c.) (U_C)	10.6 V
Nominal current at 70 °C (I_N)	0.75 A
D1 Total lightning impulse current (10/350 μ s) (I_{imp})	3 kA
D1 Lightning impulse current (10/350 μ s) per line (I_{imp})	1.5 kA
C2 Total nominal discharge current (8/20 μ s) (I_n)	10 kA
C2 Nominal discharge current (8/20 μ s) per line (I_n)	5 kA
Voltage protection line-line for I_n C2 (U_P)	≤ 32 V
Voltage protection level line-PG for I_n C2 (U_P)	≤ 600 V
Voltage protection level line-line for I_n C1 (U_P)	≤ 32 V
Voltage protection level line-PG for I_n C1 (U_P)	≤ 600 V
Voltage protection level line-line for 1 kV/ μ s C3 (U_P)	≤ 20 V
Voltage protection level line-PG for 1 kV/ μ s C3 (U_P)	≤ 600 V
Series resistance per line	1 ohms
Cut-off frequency line-line (f_C)	2.6 MHz
Capacitance line-line (C)	≤ 2.5 nF
Capacitance line-PG (C)	≤ 16 pF
Operating temperature range (T_U)	-40 °C ... +80 °C
Operating state / fault indication	green / red
Degree of protection	IP 20
For mounting on	35 mm DIN rails acc. to EN 60715
Connection (input / output)	push-in / push-in
Cross-sectional area, solid	0.2-2.5 mm ²
Cross-sectional area, flexible	0.2-2.5 mm ²
Earthing via	35 mm DIN rails acc. to EN 60715
Enclosure material	polyamide PA 6.6
Colour	yellow
Test standards	IEC 61643-21 / EN 61643-21
Approvals	UL 497B, CSA, ATEX, IECEx, CCC, SIL
SIL classification	up to SIL3 ¹⁾
ATEX approvals	TÜV 20 ATEX 8527 X: II 3G Ex ec IIC T4 Gc
IECEx approvals	IECEx TUR 20.0063X: Ex ec IIC T4 Gc
China Compulsory Certification	CCC no. 2021312304001192
Extended technical data:	-----
- Max. discharge current (8/20 μ s) [1/2 - PG], [1+2 - PG] (I_{max})	20 kA
- Discharge current (8/20 μ s) [1/2 - PG], [1+2 - PG]	10 kA (10x)
- Voltage protection level line-PG at 1 kV/ μ s C3 after being subjected to I_{max} (U_P)	≤ 600 V
Weight	33 g
Customs tariff number (Comb. Nomenclature EU)	85363010
GTIN	4013364411777

Product Data Sheet: BLITZDUCTORconnect – Compact



Type	BCO CL2 BD 12
Part No.	927 942
PU	1 pc(s)

¹⁾ For details, see: www.dehn-international.com

We reserve the right to introduce changes in performance, configuration and technology, dimensions, weights and materials in the course of technical progress. The figures are shown without obligation.