

BCO ML2 B 180 (927 210)

- LifeCheck arrester monitoring and integrated status indication
- Modular two-pole arrester for lightning equipotential bonding
- For installation in conformity with the lightning protection zone concept at the boundaries from $O_A -1$ and higher

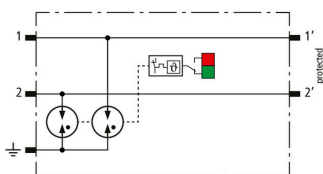

Figure without obligation



Basic circuit diagram BCO ML2 B 180

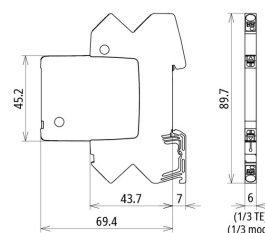

Dimension drawing BCO ML2 B 180

Space-saving, modular lightning current arrester with a width of 6 mm and push-in connection technology with status indication for protecting two single lines for lightning equipotential bonding as well as indirect earthing of shielded cables. With signal disconnection for maintenance purposes.

Type	BCO ML2 B 180
Part No.	927 210
SPD class	TYPE 1
Impulse category	D1, C2, C3
Nominal voltage (U_N)	180 V
Max. continuous operating voltage (d.c.) (U_C)	180 V
Max. continuous operating voltage (a.c.) (U_C)	127 V
Nominal current (I_N)	1.2 A
D1 Total lightning impulse current (10/350 μ s) (I_{imp})	3 kA
D1 Lightning impulse current (10/350 μ s) per line (I_{imp})	1.5 kA
C2 Total nominal discharge current (8/20 μ s) (I_n)	10 kA
C2 Nominal discharge current (8/20 μ s) per line (I_n)	5 kA
Voltage protection level line-line for I_n C2 (U_P)	≤ 1100 V
Voltage protection level line-PG for I_n C2 (U_P)	≤ 800 V
Voltage protection level line-line at 1 kV/ μ s C3 (U_P)	≤ 950 V
Voltage protection level line-PG at 1 kV/ μ s C3 (U_P)	≤ 700 V
Series resistance per line	0 ohm(s)
Cut-off frequency line-line at 100 ohms (f_G)	150 MHz
Capacitance line-line (C)	≤ 10 pF
Capacitance line-PG (C)	≤ 13 pF
Operating temperature range (T_U)	-40 °C ... +80 °C
Operating state / fault indication	green / red
Degree of protection	IP 20
Connection (input / output)	push-in / push-in
Cross-sectional area (solid)	0.2-2.5 mm ²
Cross-sectional area (fine stranded)	0.2-2.5 mm ²
Earthing via	35 mm DIN rails acc. to EN 60715
Enclosure material	polyamide PA 6.6
Colour	yellow
Test standards	IEC 61643-21 / EN 61643-21
Approvals	UL 497B, CSA, ATEX, IECEx, CCC, SIL
SIL classification	up to SIL3 ¹⁾
ATEX approvals	TÜV 20 ATEX 8527 X: II 3G Ex ec IIC T4 Gc
IECEx approvals	IECEx TUR 20.0063X: Ex ec IIC T4 Gc
China Compulsory Certification	CCC no. 2021312304001192
Extended technical data:	-----
- Discharge current (8/20 μ s) [1/2 - PG], [1+2 - PG]	10 kA (10x)
- Voltage protection level line-PG at 1 kV/ μ s C3 after being subjected to I_{max} (U_P)	≤ 700 V
Weight	33 g
Customs tariff number (Comb. Nomenclature EU)	85363010
GTIN	4013364405585
PU	1 pc(s)

¹⁾ For details, see: www.dehn-international.com

We reserve the right to introduce changes in performance, configuration and technology, dimensions, weights and materials in the course of technical progress. The figures are shown without obligation.