

## BCO ML2 BD HF 24 (927 275)

- LifeCheck arrester monitoring and integrated status indication
- Modular two-pole arrester for optimal protection of one pair of high-frequency signal circuits
- For installation in conformity with the lightning protection zone concept at the boundaries from  $O_A - 2$  and higher

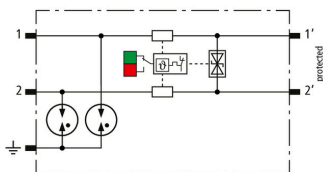

Figure without obligation



Basic circuit diagram BCO ML2 BD HF 24

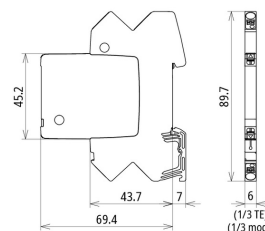

Dimension drawing BCO ML2 BD HF 24

Space-saving, modular combined arrester with a width of 6 mm and push-in connection technology with status indication for protecting one pair of unearthed high-frequency bus systems as well as balanced interfaces. With signal disconnection for maintenance purposes.

Type	BCO ML2 BD HF 24
Part No.	927 275
SPD class	<b>TYPE 4 P2</b>
Impulse category	D1, C1, C2, C3, B2
Nominal voltage ( $U_N$ )	24 V
Max. continuous operating voltage (d.c.) ( $U_C$ )	36 V
Max. continuous operating voltage (a.c.) ( $U_C$ )	25.4 V
Nominal current at 70 °C ( $I_N$ )	0.75 A
D1 Total lightning impulse current (10/350 $\mu$ s) ( $I_{imp}$ )	3 kA
D1 Lightning impulse current (10/350 $\mu$ s) per line ( $I_{imp}$ )	1.5 kA
C2 Total nominal discharge current (8/20 $\mu$ s) ( $I_n$ )	10 kA
C2 Nominal discharge current (8/20 $\mu$ s) per line ( $I_n$ )	5 kA
Voltage protection level line-line for $I_n$ C2 ( $U_P$ )	$\leq 85$ V
Voltage protection level line-PG for $I_n$ C2 ( $U_P$ )	$\leq 650$ V
Voltage protection level line-line for $I_n$ C1 ( $U_P$ )	$\leq 85$ V
Voltage protection level line-PG for $I_n$ C1 ( $U_P$ )	$\leq 650$ V
Voltage protection level line-line at 1 kV/ $\mu$ s C3 ( $U_P$ )	$\leq 48$ V
Voltage protection level line-PG at 1 kV/ $\mu$ s C3 ( $U_P$ )	$\leq 600$ V
Series resistance per line	1 ohm(s)
Cut-off frequency line-line ( $f_G$ )	100 MHz
Capacitance line-line (C)	$\leq 25$ pF
Capacitance line-PG (C)	$\leq 15$ pF
Operating temperature range ( $T_U$ )	-40 °C ... +80 °C
Operating state / fault indication	green / red
Degree of protection	IP 20
Connection (input / output)	push-in / push-in
Cross-sectional area (solid)	0.2-2.5 mm <sup>2</sup>
Cross-sectional area (fine stranded)	0.2-2.5 mm <sup>2</sup>
Earthing via	35 mm DIN rails acc. to EN 60715
Enclosure material	polyamide PA 6.6
Colour	yellow
Test standards	IEC 61643-21 / EN 61643-21
Approvals	UL 497B, SIL
SIL classification	up to SIL3 <sup>1)</sup>
Extended technical data:	-----
- Max. discharge current (8/20 $\mu$ s) [1/2 - PG], [1+2 - PG] ( $I_{max}$ )	20 kA
- Discharge current (8/20 $\mu$ s) [1/2 - PG], [1+2 - PG]	10 kA (10x)
- Voltage protection level line-PG at 1 kV/ $\mu$ s C3 after being subjected to $I_{max}$ ( $U_P$ )	$\leq 600$ V
Weight	34 g
Customs tariff number (Comb. Nomenclature EU)	85363010
GTIN	4013364468566
PU	1 pc(s)

<sup>1)</sup> For details, see: [www.dehn-international.com](http://www.dehn-international.com)

We reserve the right to introduce changes in performance, configuration and technology, dimensions, weights and materials in the course of technical progress. The figures are shown without obligation.