

**D BEB 0 - 70 / EBS 15-03-19 (419 001)**

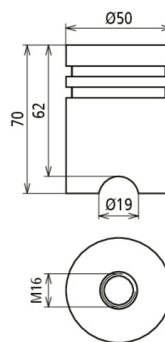

Figure without obligation



**Stainless steel earthing bridges**

The earthing bridges are designed for earthing, current return circuits and equipotential bonding in railway line applications. The stainless steel earthing bridge ensures this via a defined welding seam to the earthing conductor. This earthing bridge also has a technical approval from DB Netz AG and can be reliably used in planning.

Type	D BEB 0 - 70 / EBS 15-03-19
Part No.	419 001
Material of connection element	StSt
Material No.	1.4301
Short-circuit current	> 25 kA
Test current	40 kA / 100 ms
Standard	Ril 997.0205A01
Short-circuit current (AC 50 Hz / DC) (1 s; ≤ 300°C)	12.6 kA
Thread	M16
Diameter of connection plate	50 mm
Total height	70 mm
Installation height	62 mm
DB drawing No.	3 Ebs 15.03.19 - 37
Weight	950 g
Customs tariff number (Comb. Nomenclature EU)	85369010
GTIN	4013364439429
PU	1 pc(s)

We reserve the right to introduce changes in performance, configuration and technology, dimensions, weights and materials in the course of technical progress. The figures are shown without obligation.