

D BEB 16 - 105 / 3 EBS 15-03-19-38 (419 160)

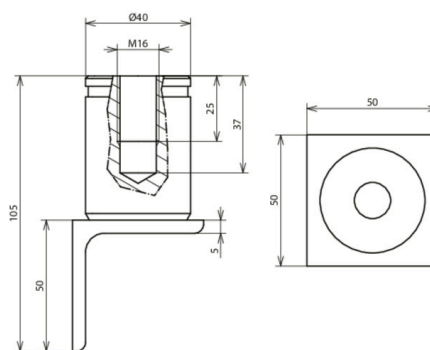

Figure without obligation

Earthing bridge D BEB 16, for the internal earthing of concrete components

The railway earthing bridge made of solid stainless steel is intended for use for internal earthing, return circuits and equipotential bonding in the field of railway lines (noise barriers). The welded-on steel angle enables easy welding to the base reinforcement and thus ensures a permanent connection. This earthing bridge also has the technical approval of DB Netz AG and can be used there without hesitation in planning.

Type	D BEB 16 - 105 / 3 EBS 15-03-19-38
Part No.	419 160 <small>NEW</small>
Material of connection element	StSt
Material No.	1.4301
Angle material	St
Short-circuit current	> 25 kA
Test current	40 kA / 100 ms
Standard	Ril 997.0205A01
Short-circuit current (AC 50 Hz / DC) (1 s; ≤ 300°C)	12.6 kA
Thread	M16
Diameter of connection plate	40 mm
Angle dimensions (l x w x d)	50 x 50 x 5 mm
Total height	105 mm
DB drawing No.	3 Ebs 15.03.19 - 38
Weight	698 g
Customs tariff number (Comb. Nomenclature EU)	85369010
GTIN	4013364510203
PU	8 pc(s)

We reserve the right to introduce changes in performance, configuration and technology, dimensions, weights and materials in the course of technical progress. The figures are shown without obligation.