

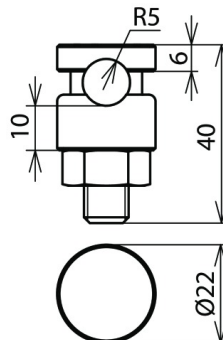

## KSV 6.10 V4A (301 089)



Figure without obligation



Arrangement:

Type	KSV 6.10 V4A
Part No.	301 089
Material of clamping screw	StSt (V4A)
Material of clamp	StSt (V4A)
Material of nut	StSt (V4A)
Material No.	1.4571 / 1.4404 / 1.4401
Clamping range Rd	6-10 mm
Connection (single-wire / multi-wire)	25-70 mm <sup>2</sup>
ASTM / AISI:	316Ti / 316L / 316
Screw	M10
Lightning current carrying capability (10/350 µs)	$I_{imp} 100 kA / I_{imp} 50 kA$ *)
Standard	EN 62561-1
Short-circuit current (AC 50 Hz / DC) (1 s; ≤ 300°C)	3.9 kA
Weight	61 g
Customs tariff number (Comb. Nomenclature EU)	85359000
GTIN	4013364304161
PU	100 pc(s)

\*)For exact classification, see test certificate.

We reserve the right to introduce changes in performance, configuration and technology, dimensions, weights and materials in the course of technical progress. The figures are shown without obligation.